

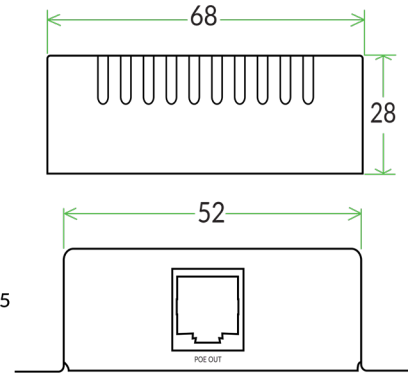

Temperature Sensor (ENV-TEMP)

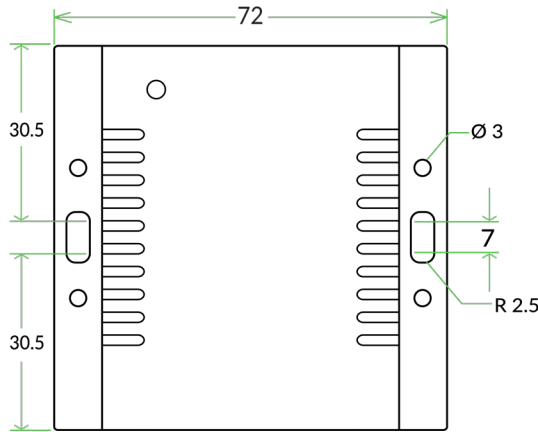
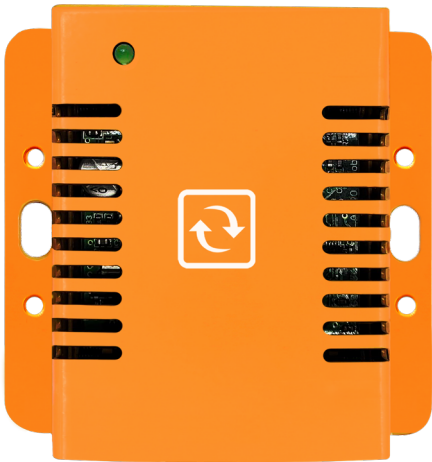

units in mm

Designed for indoor use inside data centers, server rooms and cabinets.

Sensor Metrics:

Temperature resolution	0.01°C (0.018°F)
Temperature accuracy	±0.2°C (±0.36°F) from 0°C to 90°C (32°F to 194°F)
Temperature reading	-40°C to 125°C (-40°F to 257°F)
Reading unit	in Celsius or Fahrenheit

Technical Specifications:

Powered by and communicates with	Base Unit (BASE-XX) (required)
Connectivity	RJ45 cable transmitting data & power from Base Unit to Sensor
Cable specification	RJ45 CAT 6/7 recommended Up to 100m (330ft) subject to cable quality & interference
Sensor power usage	60 mW

Environmental Specifications:

Operating temperature range	0°C to +75°C (32°F to +167°F)
Humidity (operating and storage)	< 90% rH (non-condensating)

Physical Specifications:

Sensor enclosure	Steel enclosure, industrial grade
Mounting option	0U rack, DIN rail, magnetic, or wall mountable sensor
Dimensions	68 mm (2.68") x 72 mm (2.83") x 28 mm (1.10")
Weight	120g (0.26lbs)