

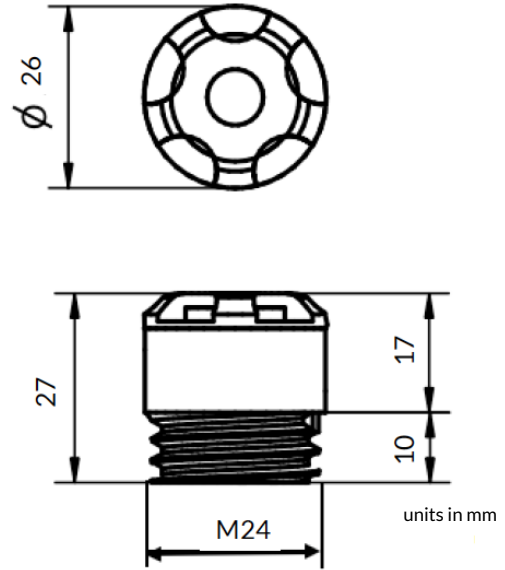

Thermography Sensor - Cylindrical Series (C-THIMG-SM)

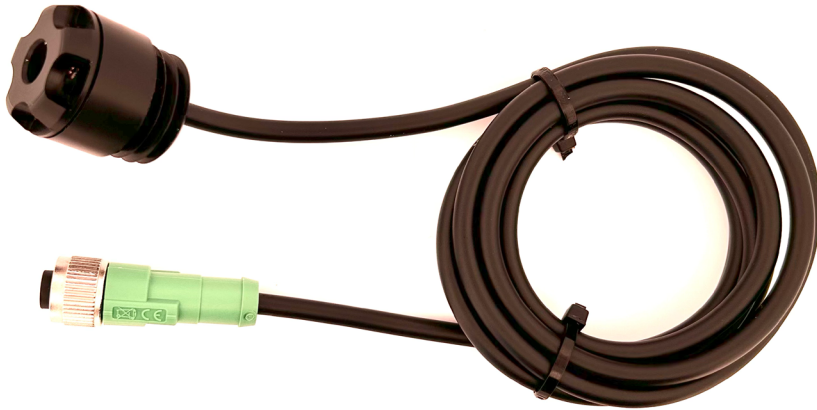

The C-THIMG-SM is a compact thermal image sensor designed for switchgear, offering a comprehensive solution to monitor all bus bars with its 768 discrete temperature measurement points and 4 reporting zones. It's mountable inside switchgear or onto existing IR windows.

Certification

To UL61010 standard pending

Sensor Metrics:

FIR target temperature range	-40°C to 300°C (-40°F to 572°F)
FIR temperature accuracy	±1°C (±1.8°F)
FIR temperature scanning	4 seconds
FIR Field of View (FoV)	110° horizontal (wide) 75° vertical
FIR max object distance	Up to 5m
FIR resolution	32x24 pixels (768 temperature measurement points)

Technical Specifications:

Powered by and communicates with	EXP-CHUB (required- which supports up to two C-THIMG-SM)
Sensor power usage	80 mW
Connectivity	Connects to the EXP-CHUB via Female Connector

Environmental Specifications:

Operating temperature range	-40°C to +85°C (-40°F to 185°F)
Humidity (operating and storage)	<90% RH (non-condensating)

Physical Specifications:

Sensor enclosure	Industrial plastic enclosure
Mounting option	Can be secured by M24 nuts
Dimensions	L: 27.5mm (1.08") Ø: 26mm (1.02")
Weight	70g (0.17lbs)
Cable specification	1.5m PVC sensor cable with female connector



Expansion Hub (EXP-CHUB)

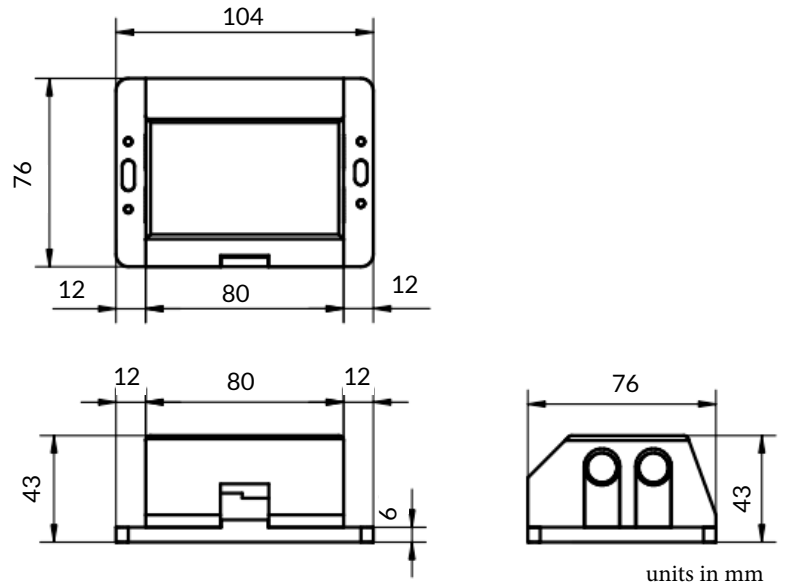
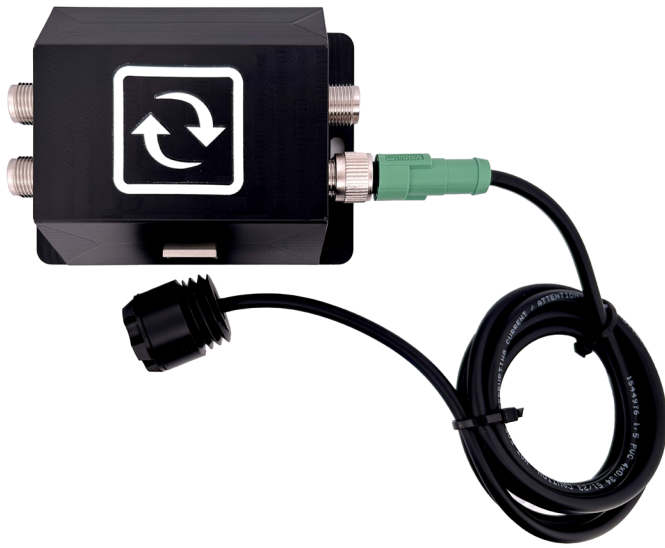

The EXP-CHUB-L features a built-in THUM and supports up to two cylindrical thermal image sensors, providing seamless integration for precise monitoring in critical applications.

Certification:

To UL61010 standard pending

Sensor Metrics:

Cylindrical hub	A standalone hub that supports up to 4 cylindrical sensors, including up to 2 thermal image sensors
Temperature measurement range	-40°C to 125°C (-40°F to 257°F)
Temperature accuracy	±0.48°C (±0.86 °F)
Relative humidity measurement range	0 to 100% RH
Relative humidity accuracy	2% RH

Technical Specifications:

Powered by and communicates with	12-24V DC (when using RS-485) or powered by BASE-XX
Power usage	500 mW (with 4 cylindrical sensors connected)
Protocol	Modbus RTU over RS485 Integration with BASE-XX over RJ45 (serial data)
Connectivity	RJ45 cable transmitting data & power from BASE-XX to EXP-CHUB Modbus cables connecting from the EXP-CHUB to Modbus master
Sensor connectivity	Four male connectors for Cylindrical sensors

Environmental Specifications:

Operating temperature range	0°C to +75°C (32°F to +167°F)
Humidity (operating and storage)	<90% RH (non-condensating)

Physical Specifications:

Sensor enclosure	Industrial plastic enclosure
Mounting option	0U rack, DIN rail, magnetic, or wall mountable sensor
Dimensions	104mm (4.09") x 76mm (2.99") x 43mm (1.7")
Weight	119g (0.26lb)
Cable specification	RJ45 CAT 6/7 recommended

The visual appearance and dimensions presented on this datasheet are for illustrative purposes only and are subject to change without prior notice. Actual product appearance and dimensions may vary due to continuous product improvement and manufacturing