

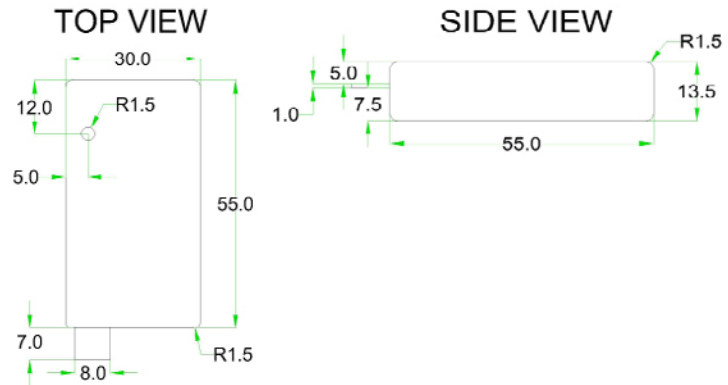

Wireless Temperature Sensor (ENV-W-TEMP) and Wireless Temperature and Humidity Sensor (ENV-W-TEMP)



General Description

Wireless temperature sensors for indoor and rack monitoring of data centers & server rooms.

Key Features

- requires the wireless hub (EXP-WHUB) and base unit.
- user replaceable 1 year battery life.
- Zigbee wireless protocol 2.4 Ghz.
- 128 bit encrypted wireless communication.
- max range is 20m line of sight with high gain antenna.
- temperature only or temperature & humidity sensor.
- Swiss made humidity probe.
- up to 15 wireless temp & humidity sensors or 30 temperature sensors per wireless hub.

Technical Specifications

Power Source: Battery Type	Coin - CR2450 (not included)
Power Usage	330 mW
Battery life time	1 year
Temperature Resolution:	0.1°C (0.18)°F precision
Temperature Accuracy:	+/- 0.5°C (+/- 0.9 °F) from -10°C to +85°C / 14°F to 185°F
Temperature Reading:	-55°C to +125°C (-67°F to +257°F)
Reading Unit	in Celsius or Fahrenheit
Relative Humidity Range:	0 to 100 % RH.
Relative Humidity Resolution or Precision	0.1 % RH and 1% RH
Relative Humidity Accuracy:	+/- 2 % RH between 10 % RH to 90 % RH and +/- 4 % RH below 10 % RH and above 90 % RH.
Relative Humidity Long Term Stability:	< 1 % RH/year.
Maximum distance to Wireless Hub:	10m / 30ft with direct line of sight or 20m/60ft with high gain antenna.

Environmental and Physical Specification

Operating temperature range	0°C to +75°C (32°F to +167°F)
Humidity (operating and storage)	< 90% rH (non-condensating).
Dimensions	55 mm (2.1") x 30 mm (1.1") x 13 mm (0.5")
Weight	0.03kg (0.07 lbs.)